

A FIRST FLOOR PLAN
SCALE: 1/4" = 1'-0"

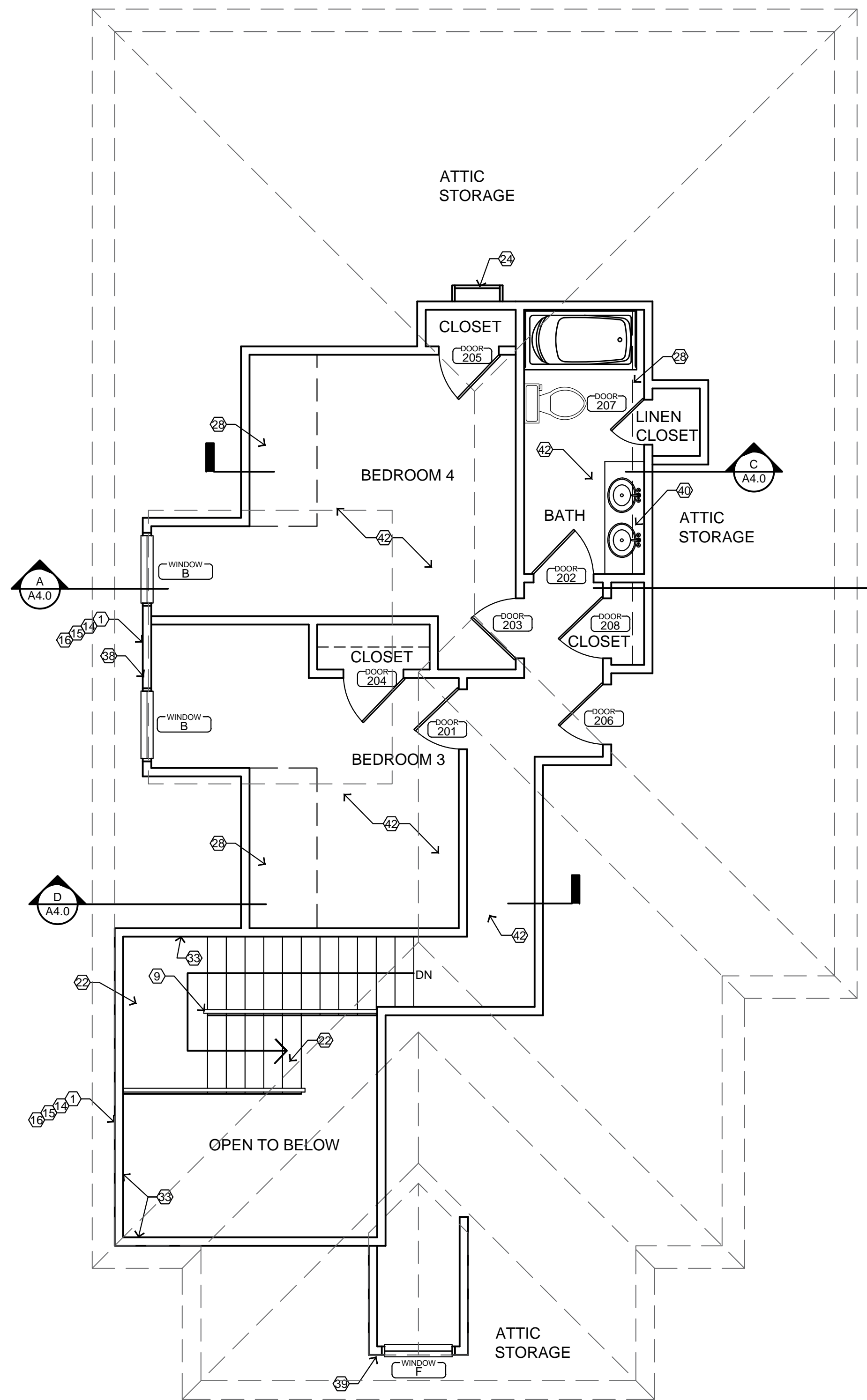

B SECOND FLOOR PLAN
SCALE: 1/4" = 1'-0"

o.c., w/ continuous 2x bottom plate, and continuous
t all ext. walls
nominal modular prefinished prefabricated base cabinet
s selected by owner. Back splash and side splash at
of splashes w/ mildew resistant silicone sealant.
actrical panel - 200 AMP service.
3" treated deck boards
nominal modular prefinished prefabricated wall hung
cabinet units. Selected by owner

6. 24" Deep x 36" High nominal modular prefinished prefabricated base cabinet units w/ countertop, as selected by owner. Back splash and side splash at walls. Seal along top of splashes w/ mildew resistant silicone sealant.
7. 36" high treated wood guardrail. Selected by owner.
8. 6x6 wood columns. wrapped with fiber cement board.
9. 36" high wood guardrail. Selected by owner.
10. Water closet, tank flush, elongated bowl. Selected by owner.
11. Closet system. Selected by owner
12. Shelves, 12" deep. Selected by owner
13. Built in cabinets and shelves.
14. Fiber cementitious siding and trim system. Profile/size selected by owner. Field paint, (2) finish coats.
15. Tyvek air barrier system with flexible self adhering membrane flashing @ doors and windows.
16. 1/2" CDX plywood sheathing - entire wall. Fasten per IRC 2012 code.
17. 36" Gas range
18. Free standing tub
19. Stand up shower with glass door and surround
20. Ceramic farmer's kitchen sink. Selected by owner
21. Driveway pavement (4000 psi mix) w/ 6x6 W6xW6 WWF in sheets. See site plan
22. Stained and sealed hardwood treads and painted wood risers.
23. Knee wall below stairs
24. 24" built in dishwasher.
25. 1/2" water for ice maker in recessed bin with 1/4" turn valve
26. Stainless steel utility sink
27. Tankless water heater
28. Sloped ceiling at roof rafters
29. 3/4" tongue and groove wood decking
30. Kitchen island. Cabinets selected by owner
31. Stud Wall - 2x6 @ 16" o.c. for plumbing
32. Condensers for HVAC
33. Ship lap walls in stair well and master bath behind tub
34. Overhead header
35. Wood beam wraps
36. Stack-able washer and dryer
37. Return air grille
38. Shed dormer
39. Dormer
40. Quartz, granite, or marble at all countertops. Selected by owner
41. Hardwood floors on first floor except bathrooms. Selected by owner
42. Luxury vinyl planks at second floor
43. Coffered ceiling. See section
44. 2x4 attic step ladder to upper ceiling
45. Linen cabinet
46. Trey ceiling to 11'-6" at master bedroom
47. No window. Fix shutters in closed position on sheathing.

GIBSON DESIGN + BUILD
 6409 CENTER STREET
 NEW ORLEANS, LOUISIANA 70124

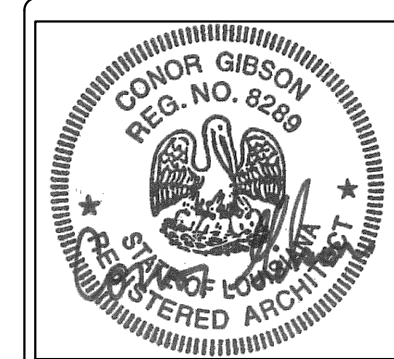

Issue: 100% CD
Date: 27 JUN 2017

Sheet:
A2.0
FLOOR PLANS