

A SECOND FLOOR PLAN
SCALE: 1/4" = 1'-0"

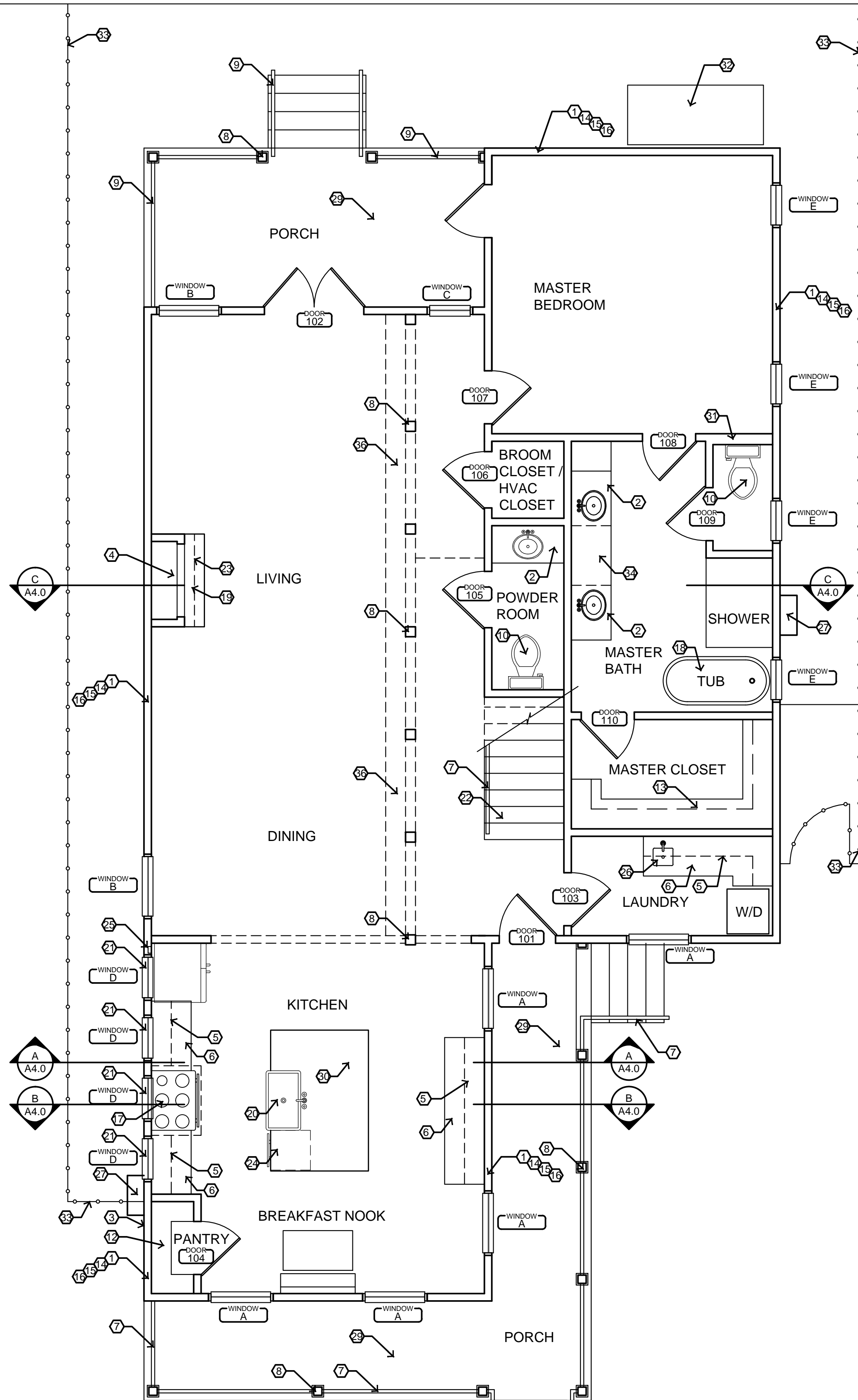

B FIRST FLOOR PLAN
SCALE: 1/4" = 1'-0"

KEY NOTES:

1. Stud Wall - 2x4 @ 16" o.c., w/ continuous 2x bottom plate, and continuous double 2x top plate. At all ext. walls
2. 21" Deep x 36" High nominal prefinished prefabricated base cabinet units w/ countertop, as selected by owner. Back splash and side splash at walls. Seal along top of splashes w/ mildew resistant silicone sealant.
3. Electric meter and electrical panel - 200 AMP service. Panel in pantry
4. Prefabricated vent free fireplace system. UL listed selected by owner.
5. 12" Deep x 42" tall nominal modular prefinished prefabricated wall hung cabinet units. Selected by owner
6. 24" Deep x 36" High nominal modular prefinished prefabricated base cabinet units w/ countertop, as selected by owner. Back splash and side splash at walls. Seal along top of splashes w/ mildew resistant silicone sealant.
7. 36" high wrought iron guardrail. Selected by owner.
8. 6x6 wrapped wood columns. Selected by owner
9. 36" high treated wood guardrail. Selected by owner.
10. Water closet, tank flush, elongated bowl. As selected by owner.
11. Closet system. Selected by owner
12. Shelves, 12" deep. Selected by owner
13. Built in cabinets and shelves.
14. Fiber cementitious siding and trim system. Profile/size selected by owner. Factory prime, field paint, (2) finish coats.
15. Tyvek air barrier system with flexible self adhering membrane flashing @ doors and windows.
16. 1/2" CDX plywood sheathing - entire wall. Fasten per IRC 2012 code.
17. 36" Gas range
18. Stand alone tub, color and style to be selected by owner.
19. Tile hearth at fireplace.
20. Ceramic farmer's kitchen sink. Selected by owner
21. Fixed clerestory windows above kitchen wall cabinets
22. Stained and sealed hardwood treads and painted wood risers.
23. Wood mantle. Selected by owner.
24. 24" built in dishwasher.
25. 1/2" water for ice maker in recessed bin with 1/4" turn valve
26. Stainless steel utility sink
27. Tankless water heater
28. Retractable attic access stair framed and mounted in ceiling
29. 3/4" tongue and groove wood decking
30. Kitchen island. Cabinets selected by owner
31. Stud Wall - 2x6 @ 16" o.c. for plumbing
32. Condensers for HVAC
33. Wood fence, extend to existing back yard fence
34. Make-up vanity at chair height with knee space
35. Wood beam wraps
36. Fur down for duct at wood beam wraps
37. Return air grille

NOTE: ALL DOORS TO BE SELECTED BY OWNER

DOOR SCHEDULE		
FIRST FLOOR		
MARK	SIZE	DESCRIPTION
101	3'-0" x 8'-0" x 1 3/4"	Solid wood door. Weatherstrip & threshold
102	2'-6" x 6'-8" x 1 3/8" (PAIR)	Exterior full glass lite, vinyl. Weatherstrip & threshold
103	2'-8" x 6'-8" x 1 3/8"	Interior solid core
104	2'-8" x 6'-8" x 1 3/8"	Interior hollow core
105	2'-8" x 6'-8" x 1 3/8"	Interior solid core
106	2'-8" x 6'-8" x 1 3/8"	Interior hollow core. Vent in door for HVAC
107	2'-8" x 6'-8" x 1 3/8"	Interior solid core
108	2'-8" x 6'-8" x 1 3/8"	Interior solid core
109	2'-8" x 6'-8" x 1 3/8"	Interior hollow core
110	2'-10" x 6'-8" x 1 3/8"	Interior hollow core

SECOND FLOOR		
MARK	SIZE	DESCRIPTION
201	2'-8" x 6'-8" x 1 3/8"	Interior hollow core
202	2'-8" x 6'-8" x 1 3/8"	Interior hollow core
203	2'-8" x 6'-8" x 1 3/8"	Interior hollow core
204	2'-8" x 6'-8" x 1 3/8"	Interior hollow core
205	2'-8" x 6'-8" x 1 3/8"	Interior hollow core
206	2'-8" x 6'-8" x 1 3/8"	Interior hollow core
207	2'-8" x 6'-8" x 1 3/8"	Interior hollow core
208	2'-8" x 6'-8" x 1 3/8"	Interior hollow core
209	2'-8" x 6'-8" x 1 3/8"	Interior hollow core
210	2'-8" x 6'-8" x 1 3/8"	Interior hollow core
211	2'-8" x 3'-6" x 1 3/8"	Interior hollow core
212	2'-8" x 3'-6" x 1 3/8"	Interior hollow core
213	2'-8" x 3'-6" x 1 3/8"	Interior hollow core

NOTE: ALL WINDOWS TO BE SELECTED BY OWNER

WINDOW SCHEDULE			
MARK	SIZE	SILL HEIGHT	DESCRIPTION
A	3'-0" x 8'-0"	FLOOR	Single hung 4/4 lite, insulated glass
B	3'-0" x 5'-0"	2'-0"	Single hung 4/4 lite, insulated glass
C	2'-0" x 5'-0"	2'-0"	Single hung 4/4 lite, insulated glass
D	2'-0" x 1'-6"		Clerestory 8'-7" Fixed, insulated glass
E	2'-0" x 4'-4"	2'-8"	Single hung 1/1 lite, insulated glass

RESIDENCE FOR MANGINA
 CONSTRUCTION LLC
 905 NAVARE AVENUE
 NEW ORLEANS, LOUISIANA 70124

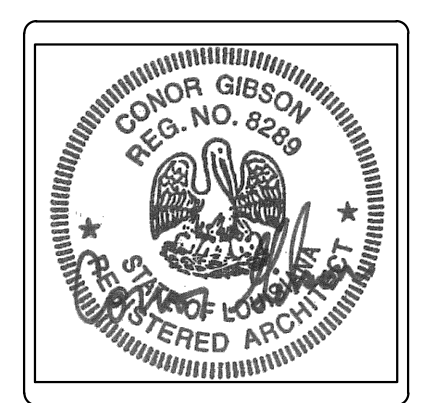

Issue: 100% CD
Date: 05 DEC 2016

Sheet:
A2.0
FLOOR PLANS